



HALE

SOLID. SINCE 1907.

4X LOCKABLE COMPARTMENTS

COAT HANGING ROD

2" THICK UPHOLSTERED CUSHION (FABRIC TBD)

BOOT STORAGE

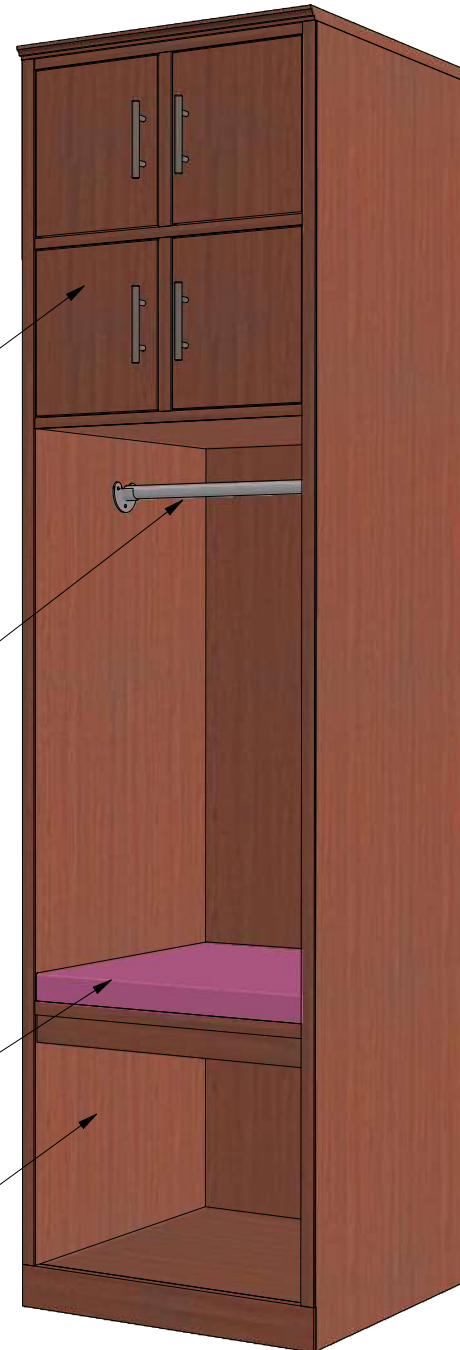

MATERIAL	QTY
TBD	

NOTES
1.) These are concept drawings, changes may occur after further engineering and customer feedback.

2.) Colors shown don't represent finish on final product, they are only for reference.

3.) Any Door pulls or edge profiles shown in these drawings can be changed if needed, with the exception of pulls shown on sliding glass doors.

ENGINEER ALEX L

ENGINEERING REV 1 8/3/2020

APPROVAL ___ / ___
ROUGH MILL ___ / ___
SLIDER ___ / ___
MACHINING ___ / ___
ASSEMBLY ___ / ___
FINISHING ___ / ___

SHEET



HALE

SOLID. SINCE 1907.

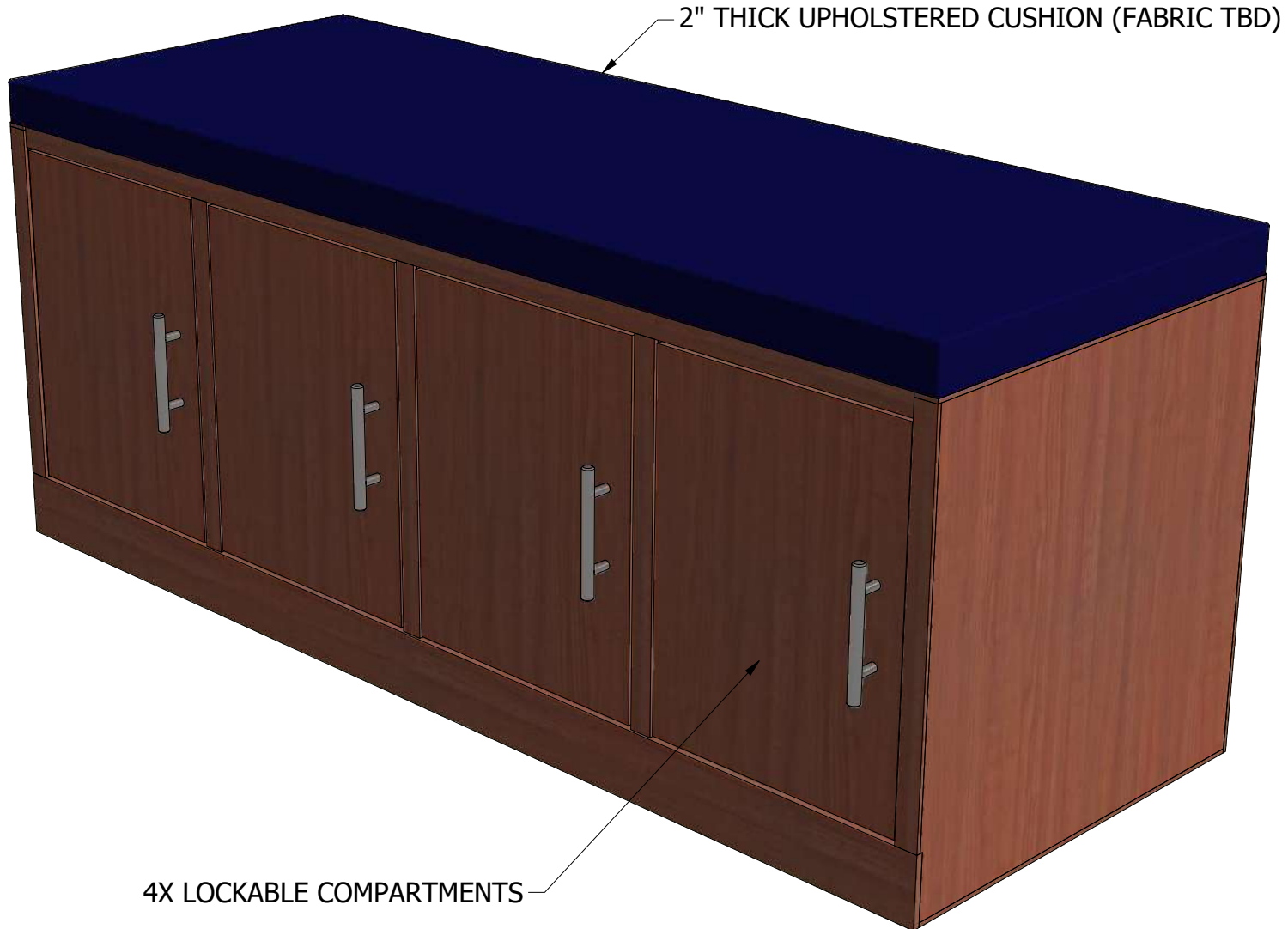

2" THICK UPHOLSTERED CUSHION (FABRIC TBD)

4X LOCKABLE COMPARTMENTS

MATERIAL	QTY
TBD	

NOTES
 1.) These are concept drawings, changes may occur after further engineering and customer feedback.

2.) Colors shown don't represent finish on final product, they are only for reference.

3.) Any Door pulls or edge profiles shown in these drawings can be changed if needed, with the exception of pulls shown on sliding glass doors.

ENGINEER ALEX L

ENGINEERING
REV 1 8/3/2020

APPROVAL	__ / __
ROUGH MILL	__ / __
SLIDER	__ / __
MACHINING	__ / __
ASSEMBLY	__ / __
FINISHING	__ / __

SHEET



HALE

SOLID. SINCE 1907.

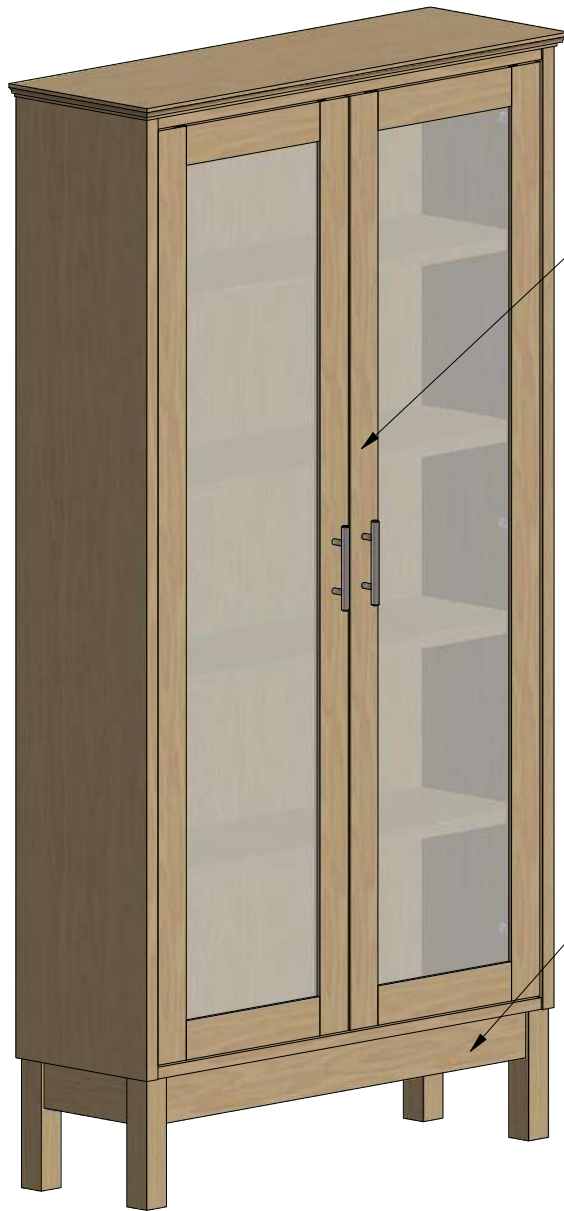

1 SET OF HINGED LOCKING WOOD DOORS

P-BOTTOM BOOKCASE TO SIT ON LEG BASE
(200 LINE MADE TO RESEMBLE 754)

MATERIAL	QTY
MAPLE	

NOTES
1.) These are concept drawings, changes may occur after further engineering and customer feedback.

2.) Colors shown don't represent finish on final product, they are only for reference.

3.) Any Door pulls or edge profiles shown in these drawings can be changed if needed, with the exception of pulls shown on sliding glass doors.

ENGINEER
ALEX L

ENGINEERING
REV 1 8/3/2020

APPROVAL	__ / __
ROUGH MILL	__ / __
SLIDER	__ / __
MACHINING	__ / __
ASSEMBLY	__ / __
FINISHING	__ / __

SHEET



(4) ADJUSTABLE WOOD SHELVES



HALE

SOLID. SINCE 1907.

MATERIAL	QTY
MAPLE	

NOTES
 1.) These are concept drawings, changes may occur after further engineering and customer feedback.

2.) Colors shown don't represent finish on final product, they are only for reference.

3.) Any Door pulls or edge profiles shown in these drawings can be changed if needed, with the exception of pulls shown on sliding glass doors.

ENGINEER **ALEX L**

ENGINEERING
REV 1 8/3/2020

APPROVAL	__ / __
ROUGH MILL	__ / __
SLIDER	__ / __
MACHINING	__ / __
ASSEMBLY	__ / __
FINISHING	__ / __

SHEET



HALE

SOLID. SINCE 1907.



(2) RECESSED LIGHTS UNDER TOP PANEL

(4) ADJUSTABLE GLASS SHELVES

1 SET OF LOCKING, SLIDING GLASS DOORS

MATERIAL	QTY
MAPLE	

NOTES
1.) These are concept drawings, changes may occur after further engineering and customer feedback.

2.) Colors shown don't represent finish on final product, they are only for reference.

3.) Any Door pulls or edge profiles shown in these drawings can be changed if needed, with the exception of pulls shown on sliding glass doors.

ENGINEER
ALEX L

ENGINEERING
REV 1 8/3/2020

APPROVAL ___ / ___
ROUGH MILL ___ / ___
SLIDER ___ / ___
MACHINING ___ / ___
ASSEMBLY ___ / ___
FINISHING ___ / ___

SHEET